

4 Bike Carrier

2" Receiver Mounted

2896AT

Instructions:

Before installing the rack onto your vehicle

1. Assemble the bottom section per figure 1.
 - The bracket (A) bolts to the draw tube (B) using the M16x75 bolt and lock nut. Then insert the 1/2" pivot pin and retain it with the clip.
 - The tube (C) is bolted to bracket the by using (2) M12x70 bolts and lock nuts.
 - The top arm (D) is bolted to the tube by using the M8x16 bolt and lock nut.
2. Assemble the top section per figure 2.
 - Insert the tube grips (E) into the top arm (D) and the top plates (F).
 - Assemble the top plates (F) onto the top arm using the (2) screw clamps (G).
 - Add the reflector (H) as shown.

Installing the rack on your vehicle

- Place your rack receiver into your receiver hitch* (figure 3).
- Fit rack as close to the vehicle as possible using the two holes in the draw tube (B) and secure your rack with the 5/8" hitch pin and clip (J).
- Check to ensure rack is secure and pivot pin is in place.

Loading bikes on your rack

- Loosen or remove the top plates (F). Place bike top tubes into the vinyl tube grips (E).
- After placing a maximum of 4 bikes on your rack, replace top plates and tighten knobs evenly. (Sloping top tube bikes may sit on an angle**).

IMPORTANT NOTES:

1. Alternate direction of handlebars when carrying 4 bikes. (See bicycle mounting options).
2. To prevent the front wheels and handlebars from moving about during transport, we recommend a nylon strap or standard bungee cord, routed through the wheel spokes and around the down tube of the bike frame.
3. To lock bikes onto your rack, use a standard Master Lock® padlock through the holes in the top plates. We also recommend running a cable from the padlock through both wheels and back. This is to ensure quick release wheels can't be removed. Your rack may also be locked to the tow hitch with a padlock and cable or locking pin*** if desired.

* Minimum ground clearance to base of rack is 14 inches.

** See your retailer for a bike adapter that will allow sloping tube bicycles to sit level on your rack.

*** Ask your retailer about locking hitch pins.

Mounting the 4 Bike Rack on a trailer or 5th wheel:

1. Purchaser is advised that the load created by rack and bicycles may exceed the strength of trailer or 5th wheel bumper or other mounting location. Failure through improper mounting will void rack warranty.
2. The recommended 14" ground clearance is not sufficient on trailers or 5th wheels. Ground clearance must exceed 15" and will vary upon application. Damage to bicycles or rack due to ground clearance problems on trailers or 5th wheels is not covered by warranty.

Maximum weight capacity of bike rack is 180 lbs.

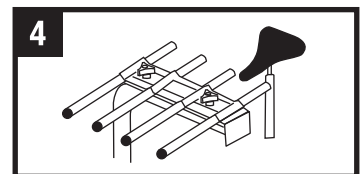
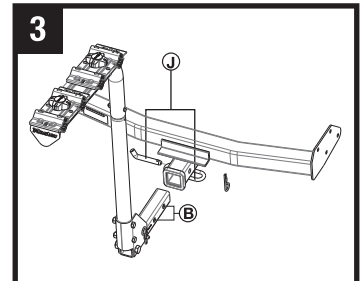
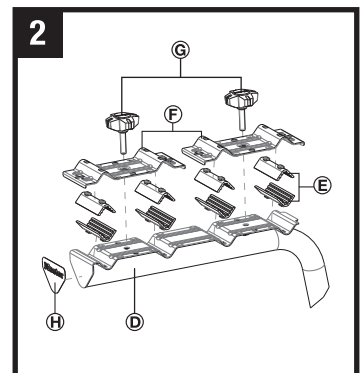
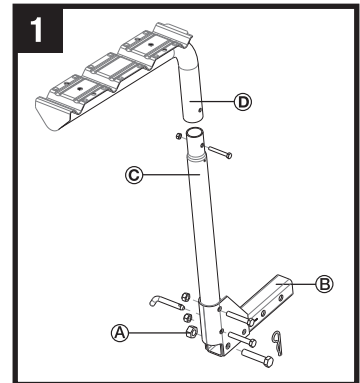

Bike Mounting Options

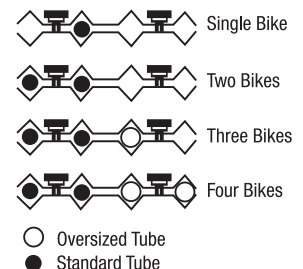

78427

www.masterlock.com

Master Lock Company LLC, Milwaukee, WI 53154 U.S.A. | 800-308-9244
Master Lock Canada, Oakville, Ontario L6H 5S7 Canada | 800-227-9599
© 2007 Master Lock Company | All Rights Reserved.

Rev 04/07

Master Lock®