

### 3812AT Installation Instructions

GROSS LOAD CAPACITY WHEN USED AS A WEIGHT CARRYING HITCH: 5,000 LBS. TRAILER WEIGHT & 500 LBS. TONGUE WEIGHT.

**\*\*\*DO NOT EXCEED VEHICLE MANUFACTURER'S RECOMMENDED TOWING CAPACITY.\*\*\***

Parts List			
ITEM	QTY	PART / NUMBER	DESCRIPTION
1	1	1/2"	FISHWIRE TOOL
2	2	1/2-13 x 3 1/2"	HEX BOLT
3	8	1/2"	LOCK WASHER
4	8	1/2-13	HEX NUT
5	6	1/2 - 13 x 1 1/2	HEX BOLT
6	6	1/2"	WASHER

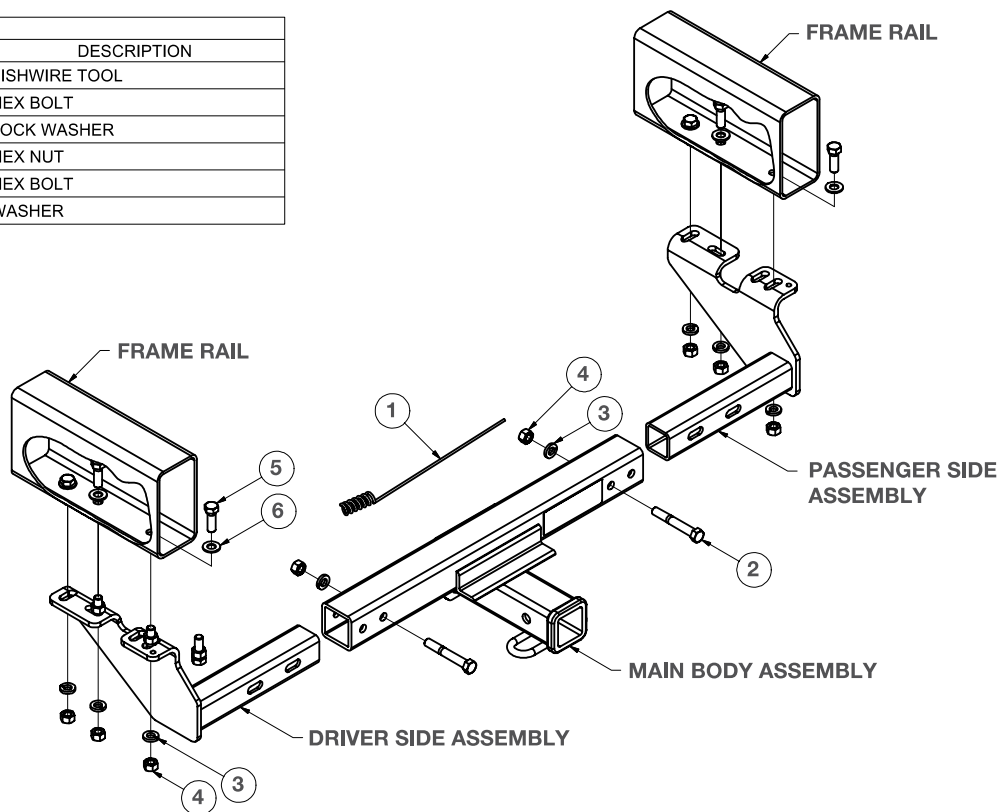
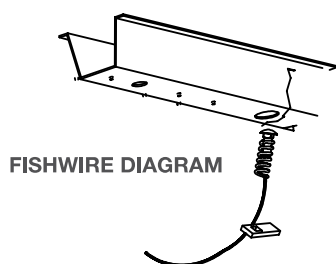

HITCH WEIGHT: 42 LBS.

INSTALL TIME: 60 MINUTES

INSTALL NOTES:

- DRILLING REQUIRED

- FISHWIRE FASTENERS

### INSTALLATION STEPS

1) Measure center to center distance of frame rails.

For 31" - 33-1/2" frame use holes 1 and 4.

For 35" frame use holes 2 and 4.

For 37-1/2" frame use holes 1 and 3.

For 39" frame use holes 1 and 3.

For 41" frame use holes 2 and 3.

2) Some vehicles may have one or two holes in the frame to help locate the hitch. Use the hole(s) in the frame and drill holes A, B, C, or D as recommended on the vehicle application listing on page (2)

On vehicles without frame holes. It is helpful to hold the hitch up to the frame using c-clamps, then mark and drill the holes in the frame.

On some vehicles (mostly Ford) the frame may have a rivet interfering with the installation. Remove the rivet and use the hole to bolt the hitch to the frame if desired or bolt to the frame using holes A, C, and D.

On Chevy and GMC Full-Size Vans, remove bumper bracket before installing hitch. **(Discard bracket)**

On Chevy and GMC Mini-Vans, place driver and passenger side frame rails between bumper bracket and frame. (For 1993 - 1997 Chevy Astrovan Ext. Cab, see diagram on page (3).

**(Note: installation of some models may be easier if spare tire is removed during installation. On Ford trucks, the spare tire bracket must be removed or adjusted before installing hitch.)**

PERIODICALLY CHECK THIS RECEIVER HITCH TO INSURE THAT ALL FASTENERS ARE TIGHT AND THAT ALL STRUCTURAL COMPONENTS ARE SOUND.

**FOR INSTALLATION ASSISTANCE OR TECHNICAL HELP CALL 1-800-655-1662**



- 3) Bolt driver side plate to frame using 1/2" x 1-1/2" bolts, flat washers, lock washers, and 1/2" nuts, tighten firmly.
- 4) Slide main body assembly over driver side plate insert. Slide passenger side insert into main body.  
**(Note: main body assembly can be reversed for use on Ford Vans)**
- 5) Align holes in driver side plate insert with holes in main body assembly and secure with 1/2" x 3-1/2" bolts, lock washers, and 1/2" nuts.
- 6) Align holes in passenger side plate insert with holes in main body assembly and secure with 1/2" x 3-1/2" bolts, lock washers, and 1/2" nuts.
- 7) Hold hitch up to frame and bolt passenger side plate to frame using 1/2" x 1-1/2" bolts, flat washers, lock washers, and 1/2" nuts.
- 8) Torque all 1/2" fasteners to 75 lb-ft. Driver side and passengers side insert tubes must be drawn together with the main body assembly tube to achieve metal to metal contact. This ensures proper installation.

VEHICLE

FRAME ATTACHMENT HOLES

CHEVROLET/GMC

Full-Size Blazer/Jimmy/Yukon/Tahoe  
Full-Size Pick-Ups•  
Suburban  
Full-Size Van  
Astrovan•

Drill holes A, C, and D.  
Drill holes C and D. Also use hole A\*  
Drill holes C and D. Also use hole A\*  
Drill holes C and D. Also use hole A\*  
Drill hole D. Also use holes B and C.

CHRYSLER

Minivans

Drill holes A and D.

DODGE

Full-Size Pick-Ups  
Dakota  
Ramcharger  
Caravan

Drill holes A, C, and D.  
Drill holes B, C, and D.  
Drill holes A, B, and D.  
Drill holes A and D.

FORD

Bronco  
Full-Size Pick-Ups  
Ranger, 8' Bed  
Full-Size Van

Drill holes A, C, and D.  
Drill holes A, C, and D.  
Drill holes C and D. Also use hole A.\*  
Drill holes C and D. Also use hole A or B.\*

TOYOTA

Full-Size Pick-Ups, 8' Bed

Drill holes A, C, and D.

NISSAN

Full-Size Pick-Ups, 8' Bed

Drill holes A, C, and D.

\* Existing holes in frame

• 3500# Weight Carrying  
5500# Weight Distributing

• Spare tire MUST BE removed

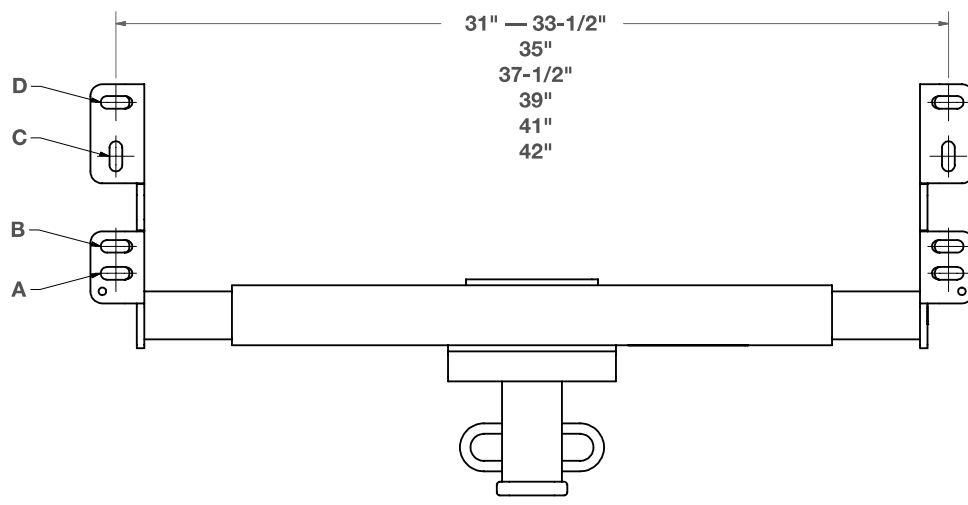

TOP VIEW

(NOTE: MAIN BODY ASSEMBLY CAN BE REVERSED FOR USE ON FORD VANS)

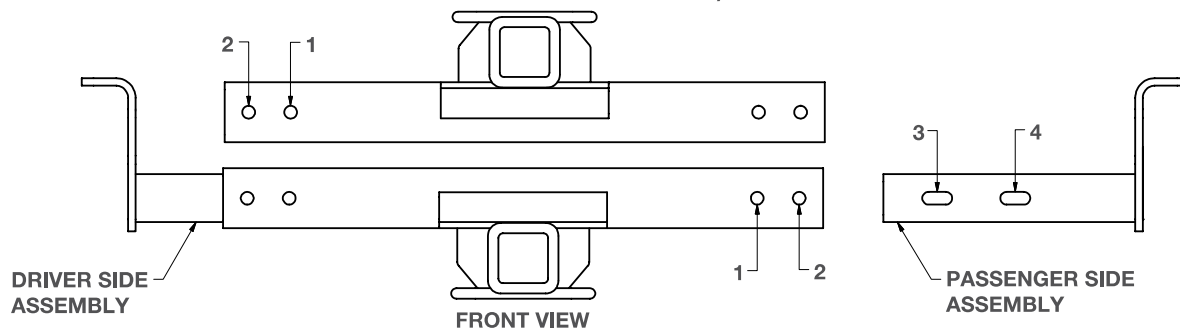

FRONT VIEW

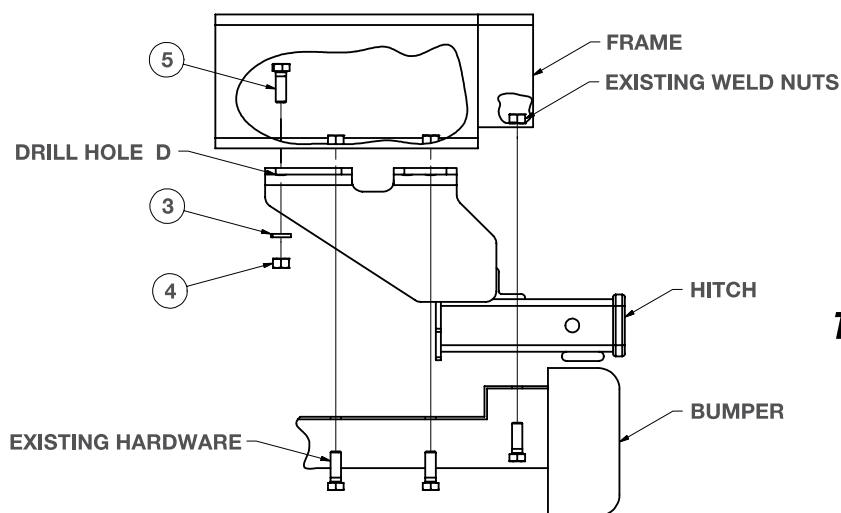

SIDE VIEW OF CHEVY ASTROVAN INSTALL

**FOR INSTALLATION ASSISTANCE OR TECHNICAL HELP CALL 1-800-655-1662**

PERIODICALLY CHECK THIS RECEIVER HITCH TO INSURE THAT ALL FASTENERS ARE TIGHT AND THAT ALL STRUCTURAL COMPONENTS ARE SOUND.



www.masterlock.com

Master Lock Company LLC, Milwaukee, WI 53154 U.S.A. | 800-308-9244

Master Lock Canada, Oakville, Ontario L6H 5S7 Canada | 800-227-9599

© 2007 Master Lock Company | All Rights Reserved