



Hover over image to zoom

MODEL NO. 1654

Locker Lock

Built-In Combination Lock for Horizontal Latch Box Lockers - Hinged on Right

BEST USED FOR



School, Employee & Health Club

OVERVIEW & FEATURES

Product Features

- Designed for standard horizontal latch box lockers with hinges on the right
- NEW octagonal, stylish dial with larger dial numbers and easy grip (black, plastic dials only)
- Springbolt action for convenient, automatic locking
- Secure, easy to dial 3-digit combination
- Longer useful life with 5 different pre-set combinations; easily changed to maintain security
- End user registration and control charts provided to secure and simplify administration
- Customize with optional color metal dials. Choose from Red, Blue, Green, Purple or Black. See catalog for details. (Metal and color dials feature the non-slip dial)
- Use Model 1676MKADA for ADA Applications
- Extension kit available for doors with a thickness of 11/16in (17mm) to 3/4in (19mm)

Product Details

Offering convenient automatic locking, the Master Lock No. 1654 Built-In Combination Lock series is designed for horizontal latch box lockers and features five different pre-set combinations for a longer, useful life in your facility. New stylish, octagonal dial with larger dial numbers provides easy grip; standard key control, used for combination changes, allows quick supervisory access. Customization options are available along with ADA compliant models.

PRODUCT SPECIFICATIONS

Product Number	1654
Description	Control Key, Retail Boxed Packaging
Master Carton Qty	50
Body Width	1-7/8 in (48 mm)
Color	Silver

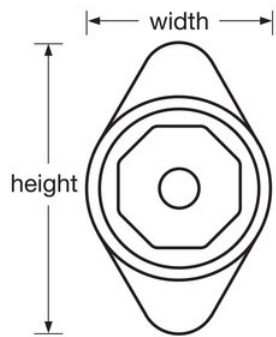

Click image to zoom